

Z-MAX™ 5e Shielded Patch Panels

Z-MAX 5e shielded patch panels provide unprecedented performance and reliability in a high-density modular solution. These complete patch panel kits combine 19 inch shielded patch panels with Z-MAX 5e shielded panel outlets to offer the industry's highest performing category 5e patching solution.

The Z-MAX shielded patch panels facilitate a world-class installation for data centers and telecommunications rooms by offering an attractive appearance combined with flexible labeling and color coding options.

These panels also accelerate installation through quick-snap module insertion and automatic grounding of modules via an embedded grounding conductor. The panel allows one- or two-hole ground lug connections to the site grounding system. This complete shielded solution provides maximum protection from outside interference and superior 5e performance. Panels are offered in flat and angled styles with fixed or removable rear cable managers.



MODULAR PATCHING

STANDARDS COMPLIANCE

- ANSI/TIA-568-C.2
- ISO/IEC 11801 Ed 2.2
- IEC 60603-7
- IEC 60603-7-3
- IEEE 802.3an
- IEEE 802.3af (PoE)
- IEEE 802.3at (PoE+)
- ANSI/TIA-1096-A

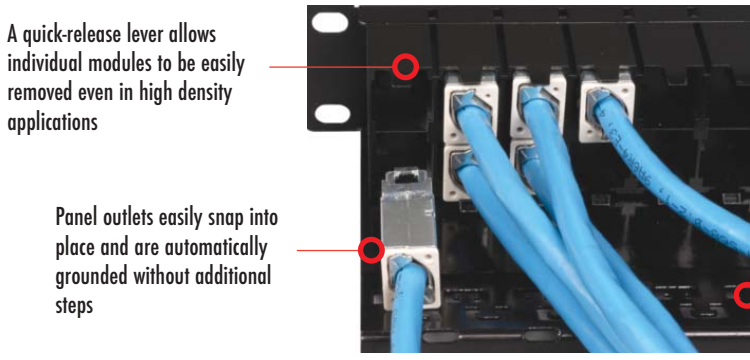
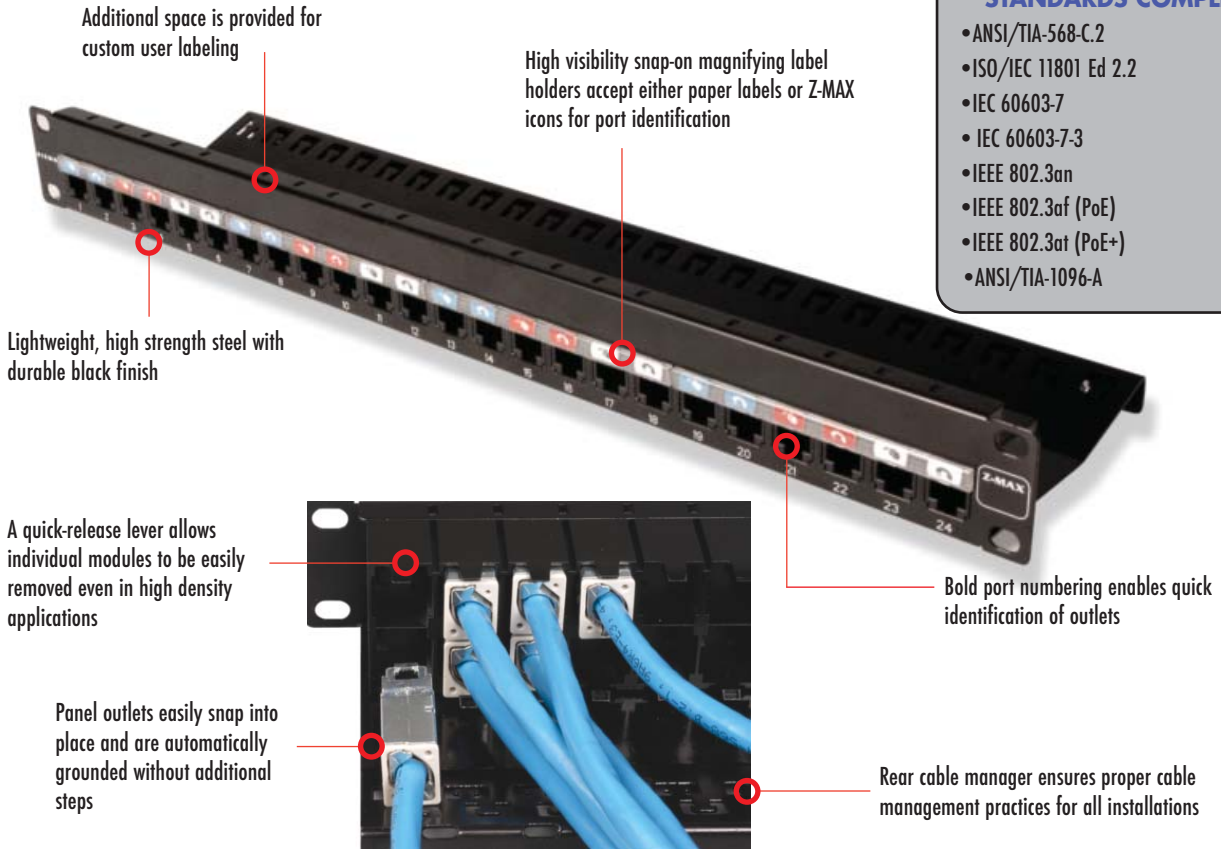

Rear cable manager ensures proper cable management practices for all installations

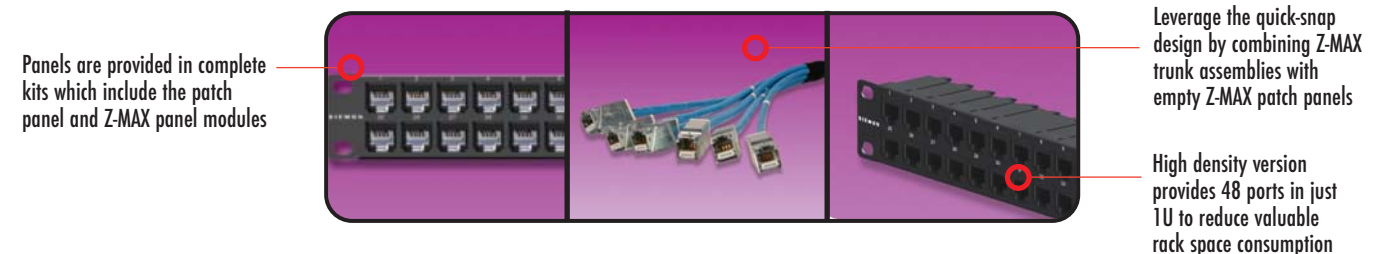

PRODUCT INFORMATION

Performance Specification Chart:

MECHANICAL – PANEL	
Operating Temperature	-10 to 60 °C, (14 to 140 °F)
Flammability Rating	UL 94 V-0
Green Features	RoHS, lead-free, halogen-free, PVC free
Plastic Materials	Flame retardant thermoplastic
Dimensions (LxWxH)	109.2 mm x 482.6 mm x 44.2 mm (4.30" x 19.00" x 1.74")
Mounting	CEA-310-E 19-inch (482.6mm) rack
Material – Panel	18 gauge cold rolled steel, black e-coat
Ground Lug Attachment	3/8" 1 hole or two-hole lug (1" spacing)



Fixed Ordering Information:

- Z5S-PNL(X)-24K.....24 Port, Z-MAX 5e shielded patch panel kit, 1 RMS, Black, with Jacks
- Z5S-PNL(X)-U48K.....48 Port, Z-MAX 5e shielded patch panel kit, 1 RMS, Black, with Jacks
- ZS-PNL(X)-24E.....24 Port, Z-MAX shielded patch panel empty, 1 RMS, Black, Empty
- ZS-PNL(X)-U48E.....48 Port, Z-MAX shielded patch panel empty, 1 RMS, Black, Empty

Use (X) to specify Panel Style.

(Blank) - Flat

(A) - Angled

Removable Ordering Information:

- Z5S-P(X)-24Z-MAX 24-Port, CAT 5e Shielded patch panel with removable wire manager kit, 1 RMS, Black, with Jacks
- Z5S-P(X)-48Z-MAX 48-Port, CAT 5e Shielded patch panel with removable wire manager kit, 1 RMS, Black, with Jacks
- ZS-P(X)-24Z-MAX 24-Port Shielded patch panel with removable wire manager, 1 RMS, Black, Empty
- ZS-P(X)-48Z-MAX 48-Port Shielded patch panel with removable wire manager, 1 RMS, Black, Empty

Use (X) to specify Panel Style.

(F) - Flat

(A) - Angled

Z-BL01

Panel Accessories

- Z-PNL-PL24.....Patch panel label sheet, numbered 1 to 24, bag of 100
- Z-PNL-PL48.....Patch panel label sheet, numbered 25 to 48, bag of 100
- Z-PNL-PPatch panel label holder, bag of 25
- Z5-SPZ-MAX 5e shielded panel outlet
- Z-BL-01Z-MAX panel blank, bag of 10, black

Panels include Z-Tool*, label / icon holders, designation labels, cable ties, grounding lug and mounting hardware.

Note: 1U = 44.5mm (1.75 in.)

* included in panel kit only

Because we continuously improve our products, Siemon reserves the right to change specifications and availability without prior notice. Z-MAX™ is a trademark of Siemon



Note: Z-MAX Shielded panels are designed for use with Z-MAX Shielded panel outlets only, for more information on panel outlets please reference outlet specifications sheet.

For additional resource information:

Visit our web site at www.siemon.com

* Termination technique may vary. See product instructions for details

Worldwide Headquarters North America

Watertown, CT USA
Phone (1) 860 945 4200 US
Phone (1) 888 425 6165

Regional Headquarters EMEA

Europe/Middle East/Africa
Surrey, England
Phone (44) 0 1932 571771

Regional Headquarters Asia/Pacific

Shanghai, P.R. China
Phone (86) 21 5385 0303

Regional Headquarters Latin America

Bogota, Colombia
Phone (571) 657 1950