

Z-MAX™ 5e SHIELDED OUTLETS

Combining exceptional category 5e performance with best-in-class termination time, the Z-MAX 5e shielded outlet is a vital part of an end-to-end Z-MAX 5e shielded cabling system. The Z-MAX module exceeds all applicable industry standards, including ANSI/TIA-568-C.2 and Amendments 1 and 2 of ISO/IEC 11801 2nd ed.

This exceptional performance is achieved through Z-MAX's innovative Z-TOOL termination process, and linear termination module that eliminates split and crossed pairs. The Z-MAX 5e shielded outlet provides maximum protection from outside interference and superior 5e performance.



PATENTED



Z-MAX™

WORK AREA

STANDARDS COMPLIANCE

- ANSI/TIA-568-C.2
- ISO/IEC 11801 Ed: 2.2 (CAT 5E)
- IEEE 802.3af (PoE)
- IEEE 802.3at (PoE+)
- IEC 60603-7
- IEC 60603-7-3
- ANSI/TIA-1096-A
- IEC 60512-99-001 (3rd party verified)

Terminates in as little as 60 seconds using the Z-Tool™

Robust die cast housing optimizes shielding from EMI and alien crosstalk

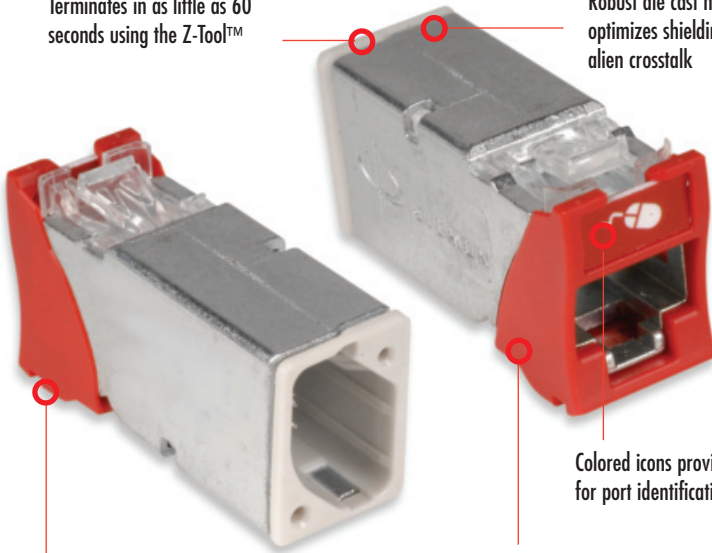

Colored icons provided for port identification

Outlets are available in a wide range of colors and mount in MAX faceplates and accessories. Keystone version also available

Pass-thru feature allows mounting from front or rear of faceplate. Also compatible with outlet door.

Zero-cross termination module accelerates lacing and eliminates pair crossing

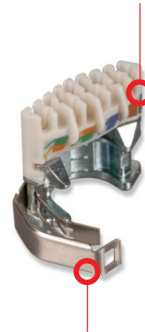

Rapid shield connection and cable jacket strain relief via integrated hinged metal clip

Optional spring loaded door minimizes exposure to dust and other contaminants.

The ergonomic and easy-to-use Z-Tool ensures a fast, low force termination

Hybrid design allows the same outlet to be mounted in flat or angled orientations

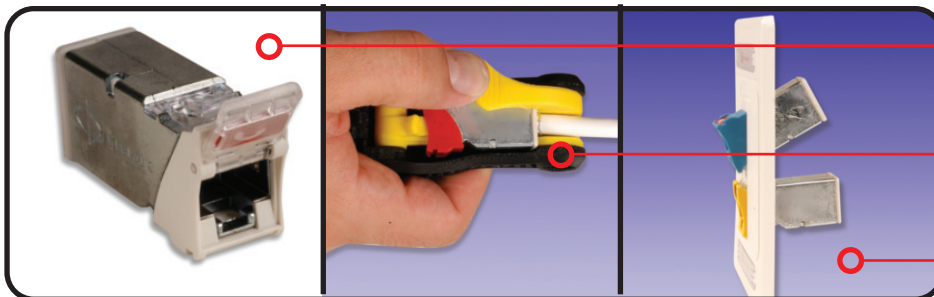

PRODUCT INFORMATION

Performance Specifications:

ELECTRICAL	
Contact Resistance	20 mΩ
Input to Output Resistance	200 mΩ
Min. Dielectric Withstand Voltage (contact to contact)	1000 AC peak
Min. Dielectric Withstand Voltage	1500 V DC (shield)
Insulation Resistance	500 mΩ
Current Rating	1.5 A
PoE	Suitable for PoE and PoE+
MECHANICAL – GENERAL	
Operating Temperature	-10 to 60 °C (14 to 140 °F)
Flammability Rating	UL 94 V-0
Green Features	RoHS, lead-free, halogen-free, PVC free
Housing Material	Zinc die cast
Contact Materials	Plated phosphor bronze, stainless steel
Plastic Materials	Flame retardant thermoplastic
Dimensions (LxWxH)	41.2x14.5x21.1mm (1.6x.570x.832 in.)
Shield	360 degree enclosure
MECHANICAL – JACK	
Number of Plug Insertion Cycles	2500
Min. Contact Force	50g
Min. Plug Retention Force	50N
Plug Compatibility	Compatible with RJ45 (8-position) or RJ11 (6-position) plugs

MECHANICAL – TERMINATION	
Wire Size Range (nominal)	23-26 AWG solid and stranded *
Wire Insulation Diameter Range (max)	1.48mm (0.058")
Conductor OD Size (max)	0.60mm (0.023")
Cable OD (max)	9mm (0.354")
Re terminations	5
Wiring	T568A/B

* Termination technique may vary. See product instructions



Z5-S(XX) Z5-S(XX)D Z5-SK(XX) Z5-SP

Z-MAX™ Shielded Outlets:

- Z5-S(XX).....Z-MAX 5e shielded module, hybrid (flat/angled)
- Z5-S(XX)D.....Z-MAX 5e Shielded module with door, hybrid (flat/angled)
- Z5-SK(XX).....Z-MAX 5e shielded module, keystone*
- Z5-SP.....Z-MAX 5e shielded panel outlet

Because we continuously improve our products, Siemon reserves the right to change specifications and availability without prior notice.

TERA®, MAX® and Z-MAX™ are trademarks of Siemon

Use (XX) to specify color:

01 = black, 02 = white, 03 = red, 04 = gray, 05 = yellow, 06 = blue, 07 = green, 09 = orange, 20 = ivory, 25 = bright white, 80 = light ivory, 82 = alpine white

The hybrid outlet mounts into MAX® mounting hardware. It includes an icon card consisting of four attached icons: one color-matching, one red, one blue, and one blank icon.

The keystone version is designed for integration with various international mounting products and is not compatible with MAX mounting hardware. The icon is not compatible with keystone outlets.

* Note: Keystone module not available with door

For additional resource information:

Visit our web site at www.siemon.com

North America
Watertown, CT USA
Phone (1) 860 945 4200 US
Phone (1) 888 425 6165 Canada

Europe/Middle East/Africa
Surrey, England
Phone (44) 0 1932 571771

Asia/Pacific
Shanghai, P.R. China
Phone (86) 21 5385 0303

Latin America
Bogota, Colombia
Phone (571) 657 1950